

1

Remove the protective film from the sandpaper, put the sandpaper to the bottom of the slot. Fold it over the edge and carefully stick it to the cylinder in the direction of the arrow.

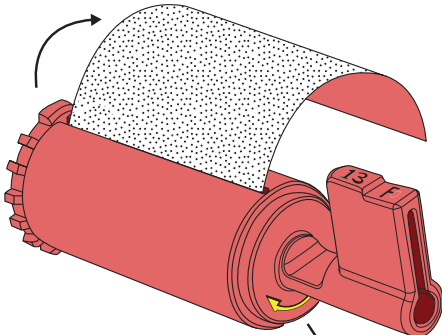

Important!
Roll on sandpaper in the arrow direction.

2

Mount the cylinders.

Make sure that the sandpaper is not located on the spikes

or outside the edge

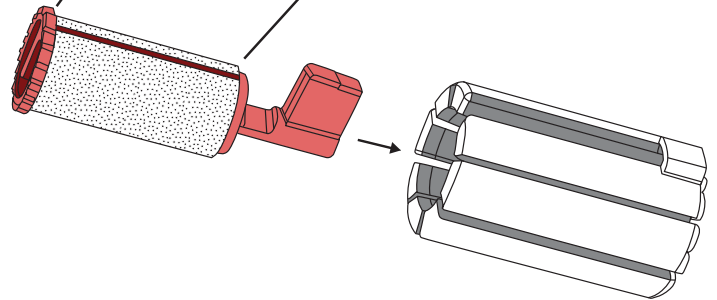

3

Pos. 1: In notches: Hollow radius **13** alt. **16**.

When the sandpaper in the used slot is consumed, turn the handle to the next notch (two flips) for new sandpaper and the same radius.

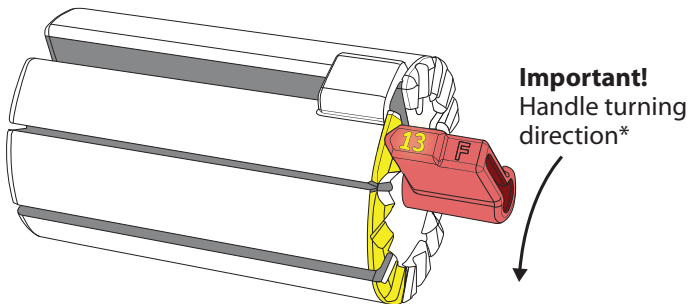

Important!
Handle turning direction*

4

Pos. 2: In slots: **F** (Flat) alt. hollow radius **20**.

When the sandpaper in the used slot is consumed, turn the handle to the next slot (two flips) for new sand paper and the same radius.

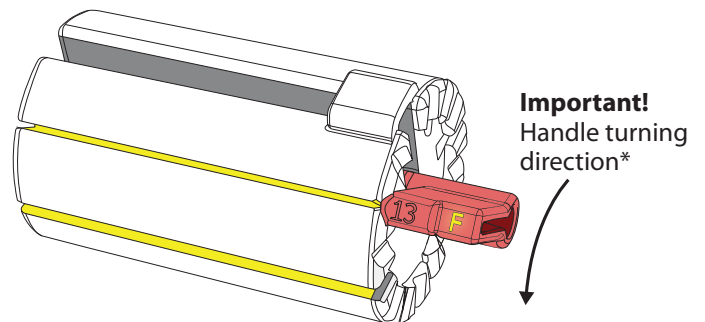

Important!
Handle turning direction*

*Turning the wrong direction can make the sandpaper jam. The direction is marked on the sharpener. If it jams, just turn the handle in the direction of the arrow until it comes loose and if necessary change sandpaper.

5

Sharpen your skate by grinding along the whole blade in the slot that fits your skate.
Do not turn the handle when the grinder is on the skate.
It can damage the spikes.

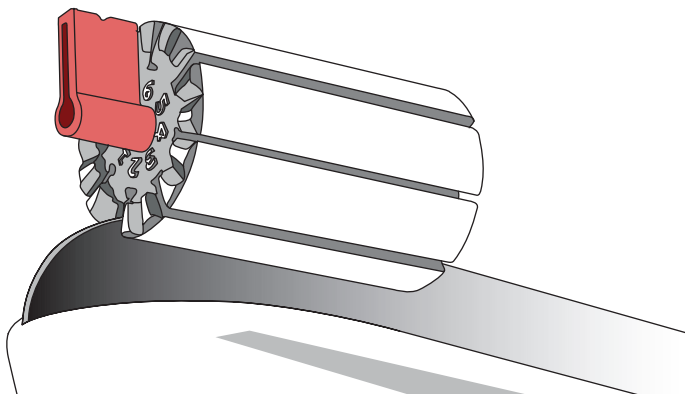

Info

This skate sharpener is meant for maintenance grinding. When the skates are new, they should first be grinded by machine, with the curve and hollow radius (or flat) desired. Thereafter the Revolver Skate Sharpener is ideal to keep the skates sharp. It sharpens skates for icehockey, bandy and tour skating.

It is made for the following radius of hollow: R13, R16, R20 and Flat grinding.

R13	R16	R20	F
13 mm	16mm	20mm	Flat
1/2"	5/8"	7/8"	Flat

NOTE: For safety reasons, wear gloves while grinding with the Revolver Skate Sharpener.